

קטלוג אובזטק למוצרי גינה וחץ

מערכת אלומיניום בחיפוי עץ

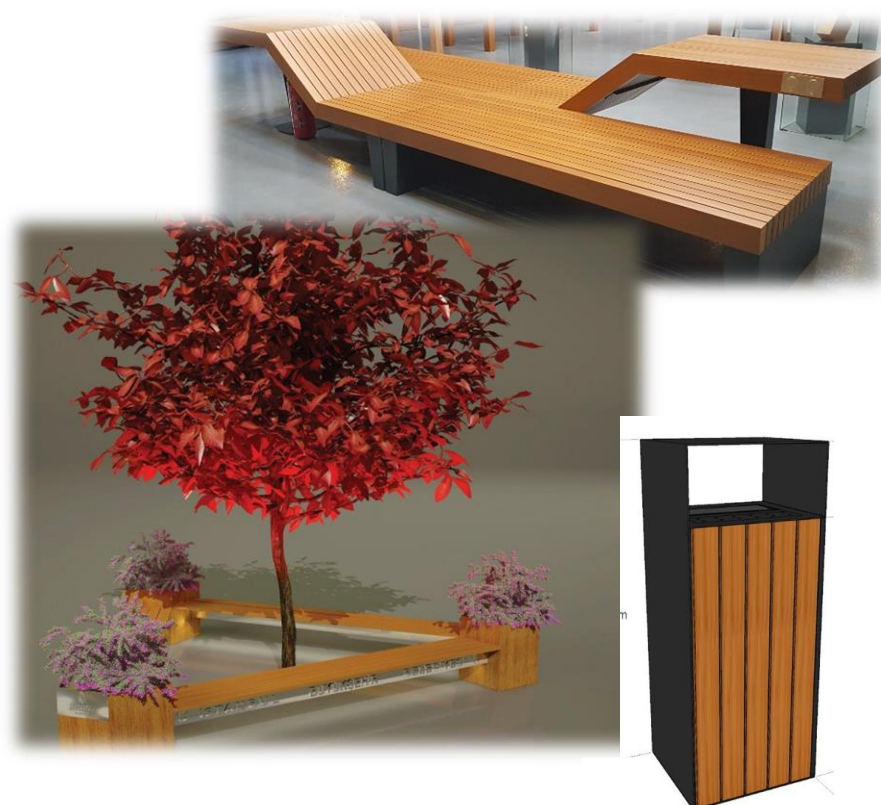

פרגולות אלומיניום בחיפוי עץ

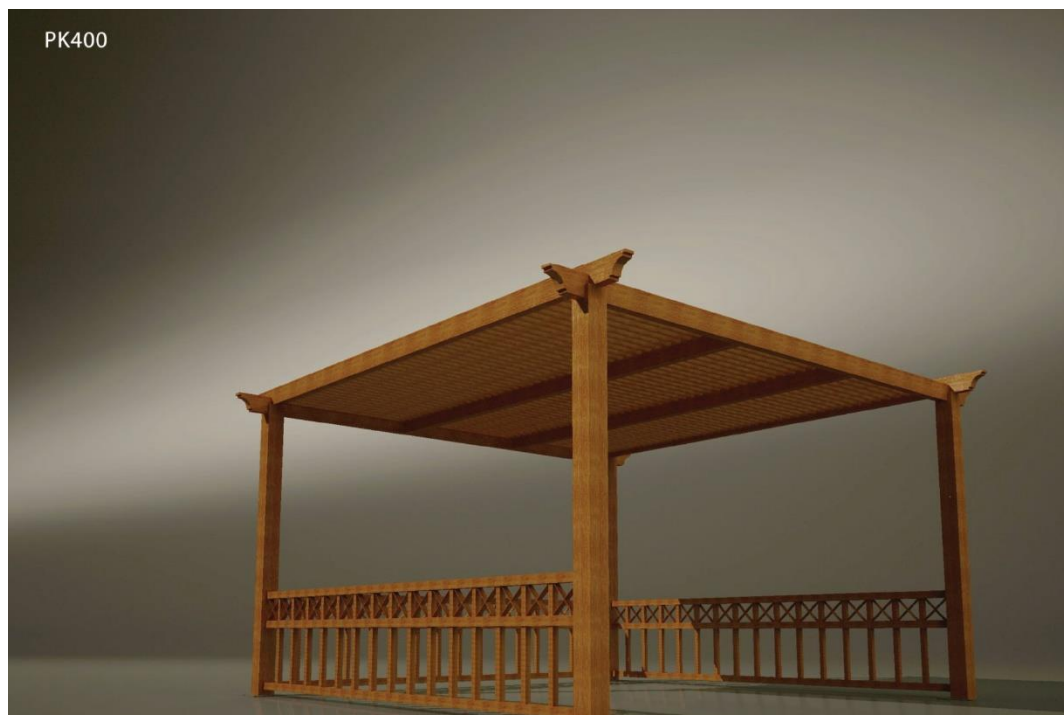

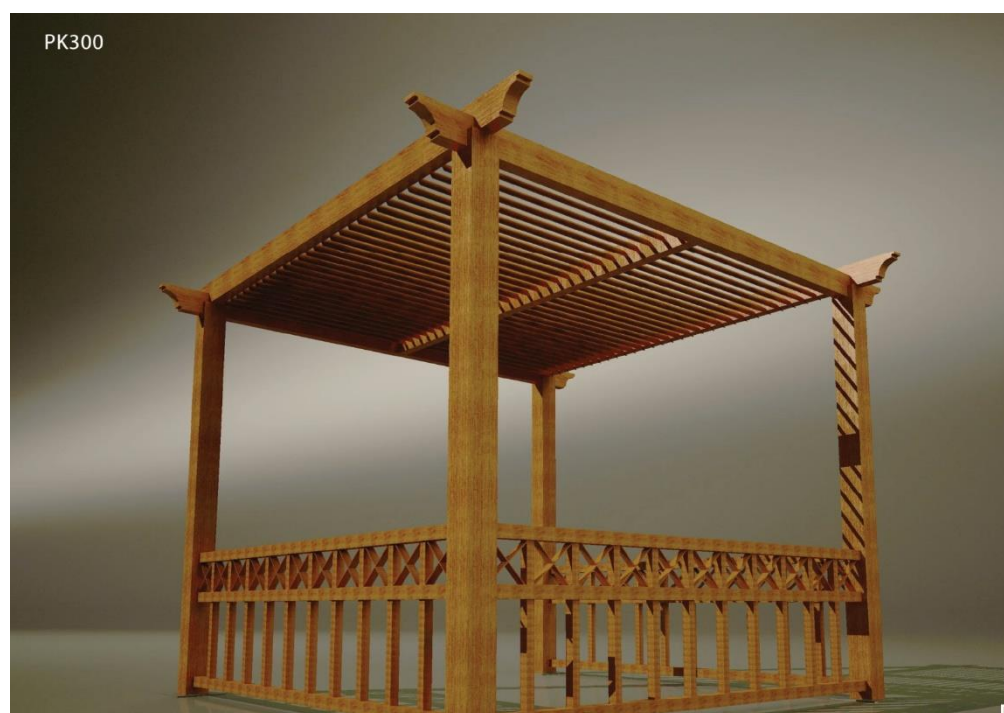



PE400

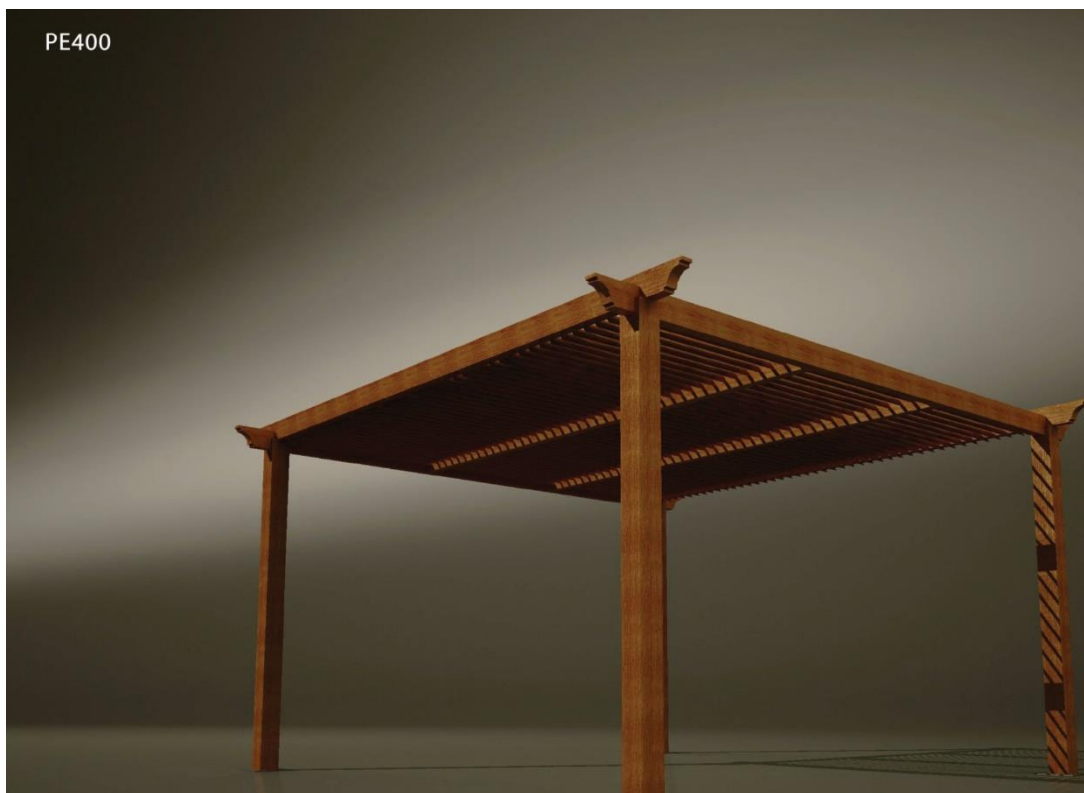

PE300



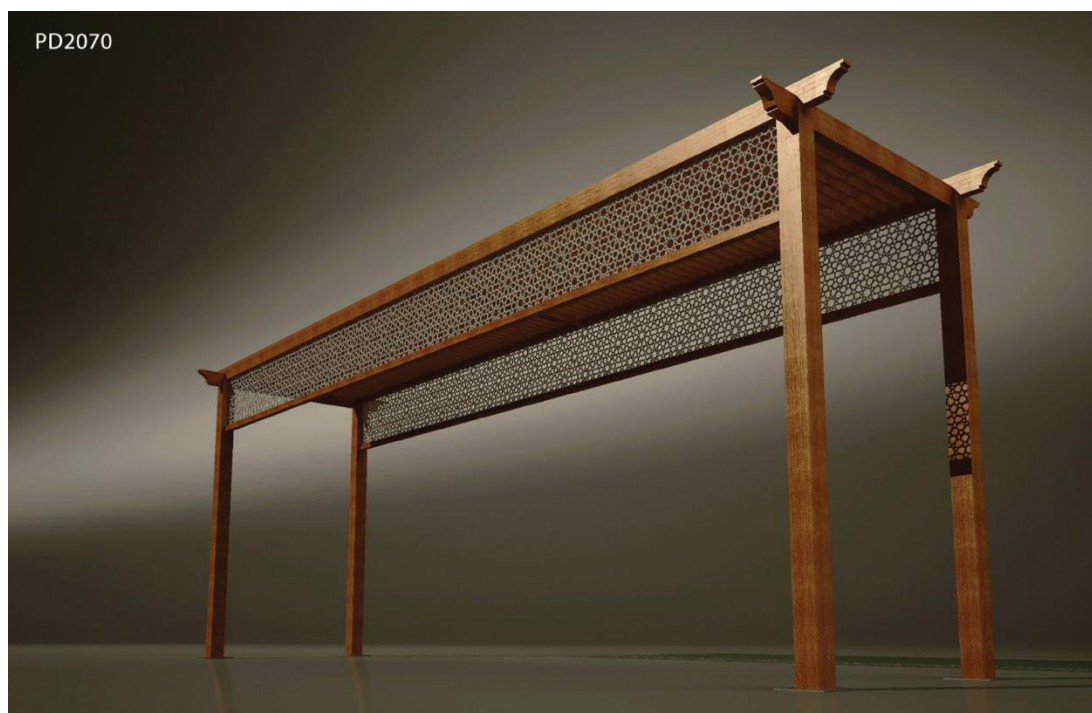

אדניות מעוצבות

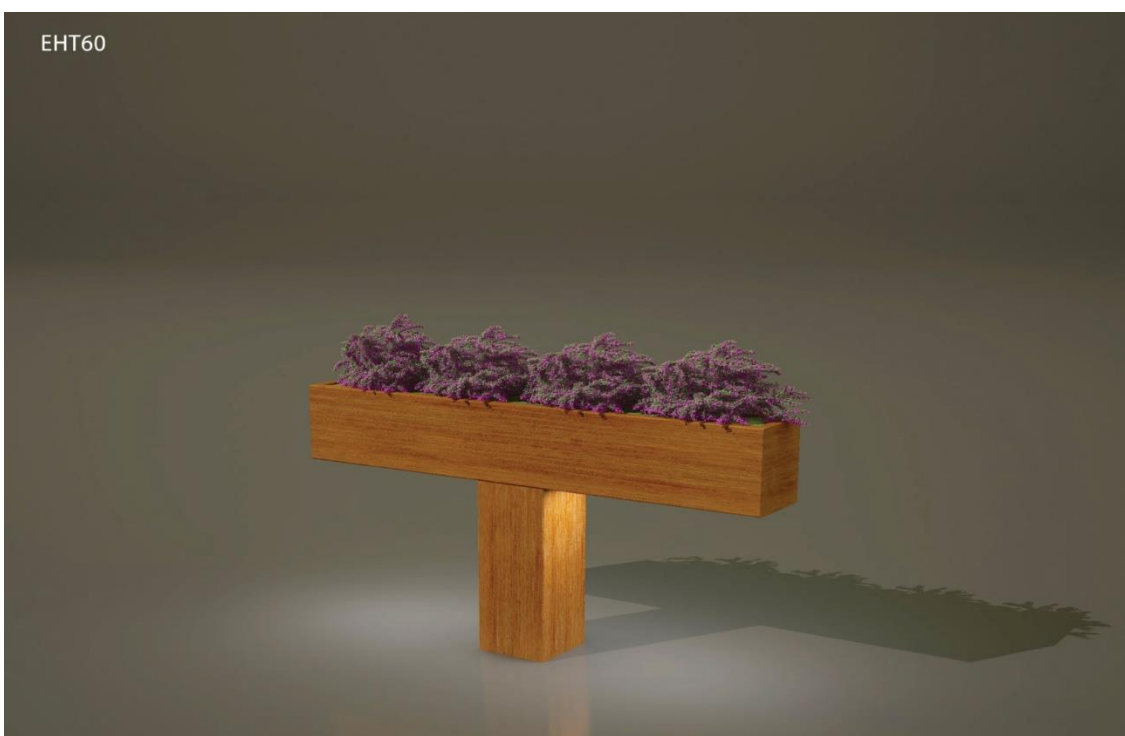

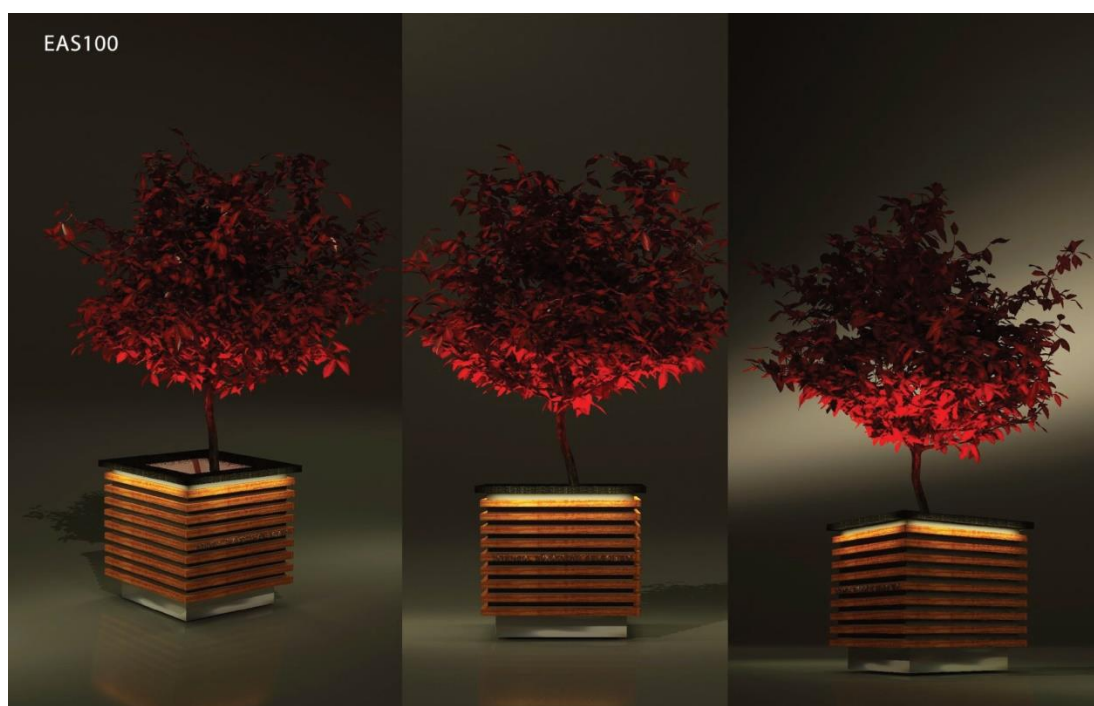
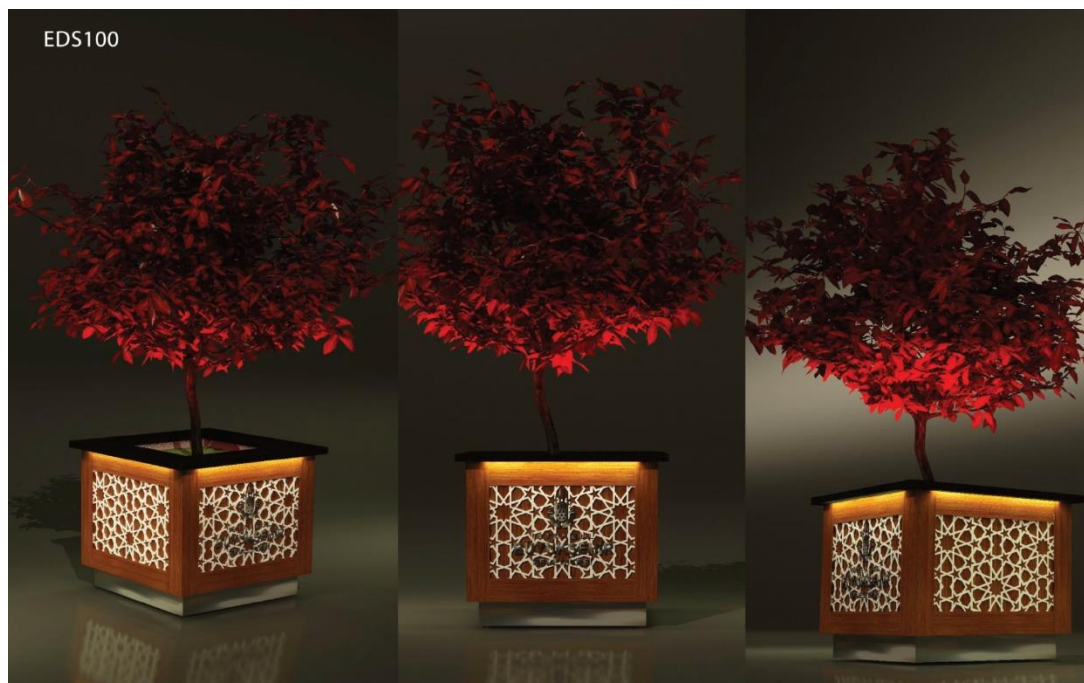

EHB80

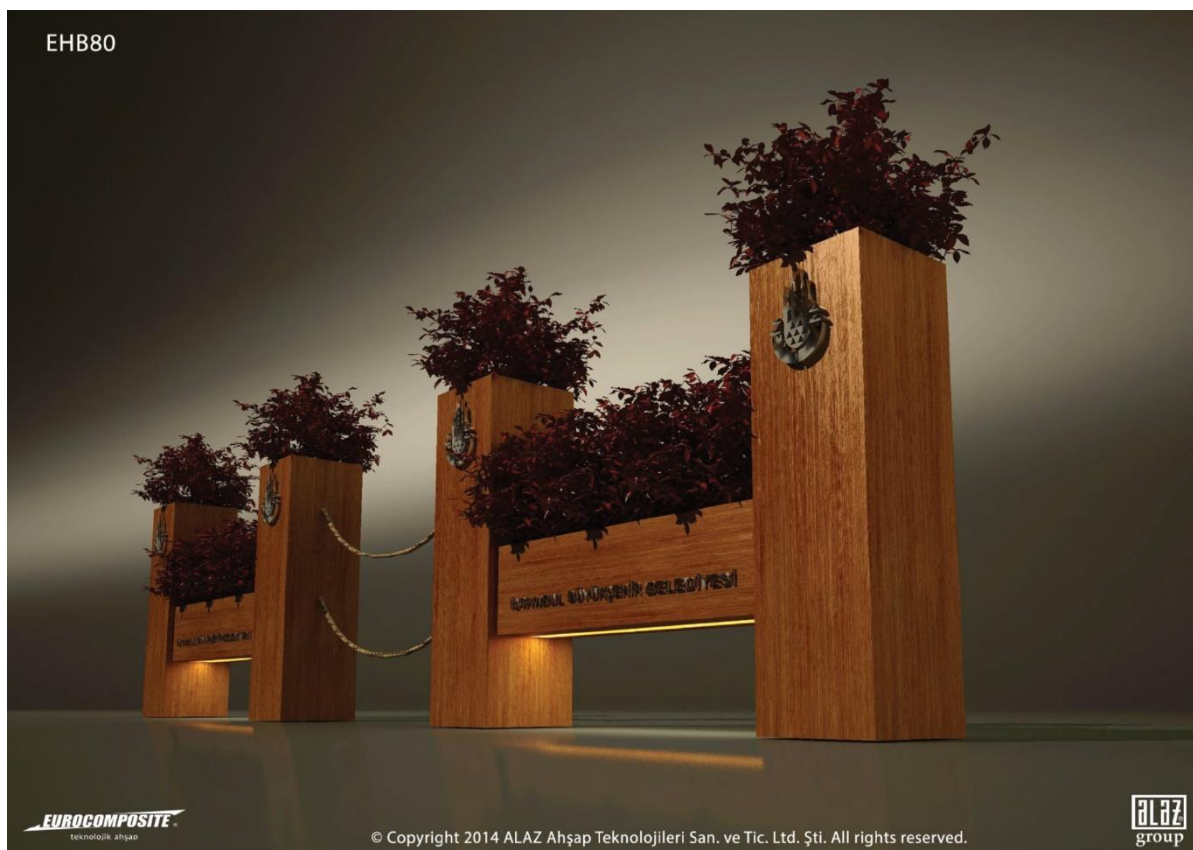

ספסלים ופינות ישיבה

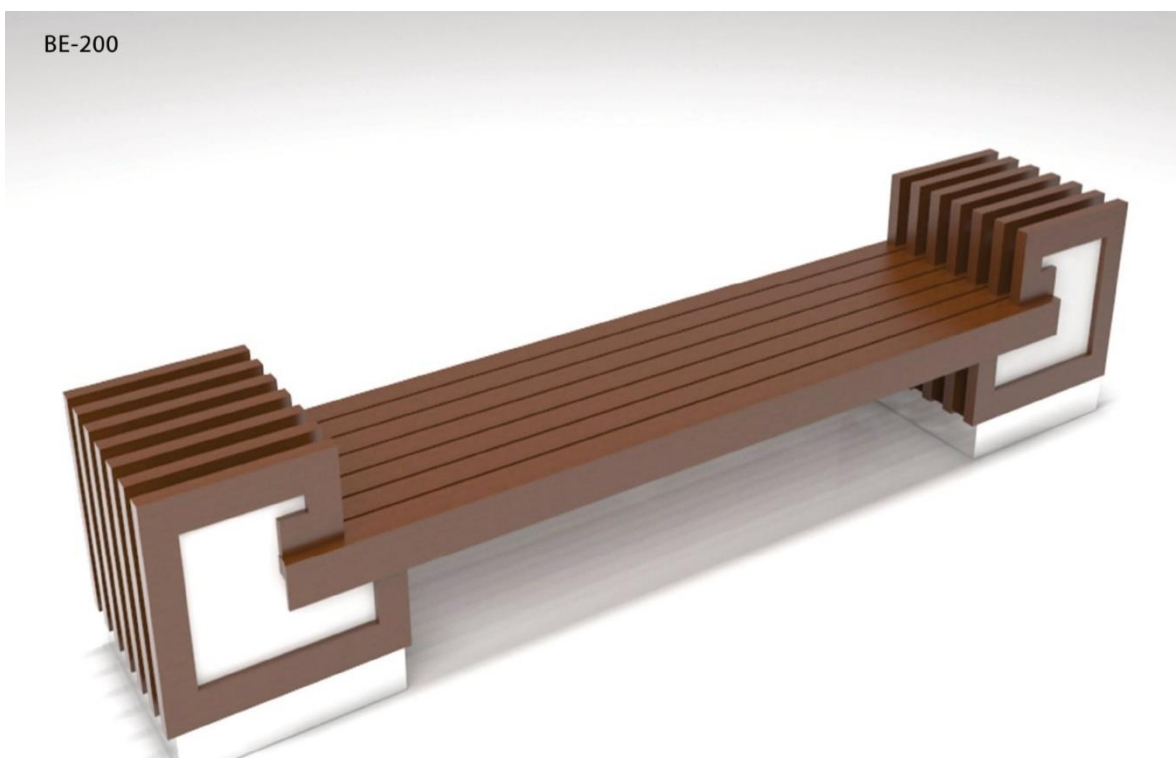

BS100

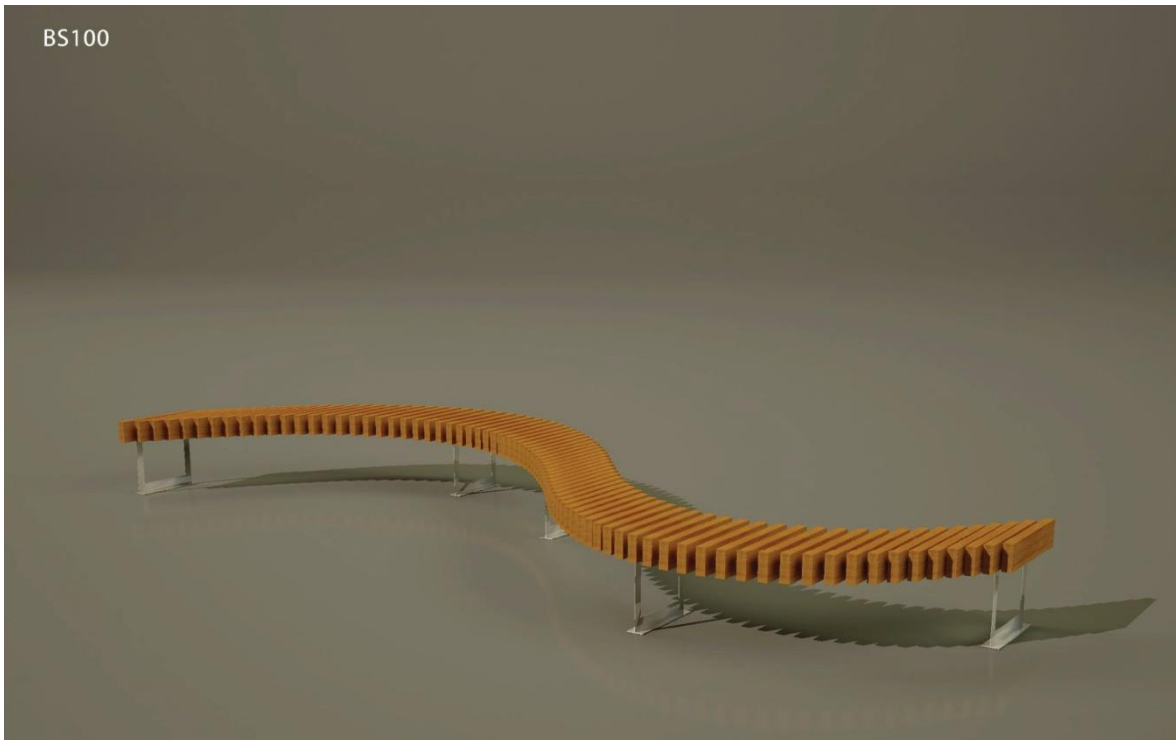

B600

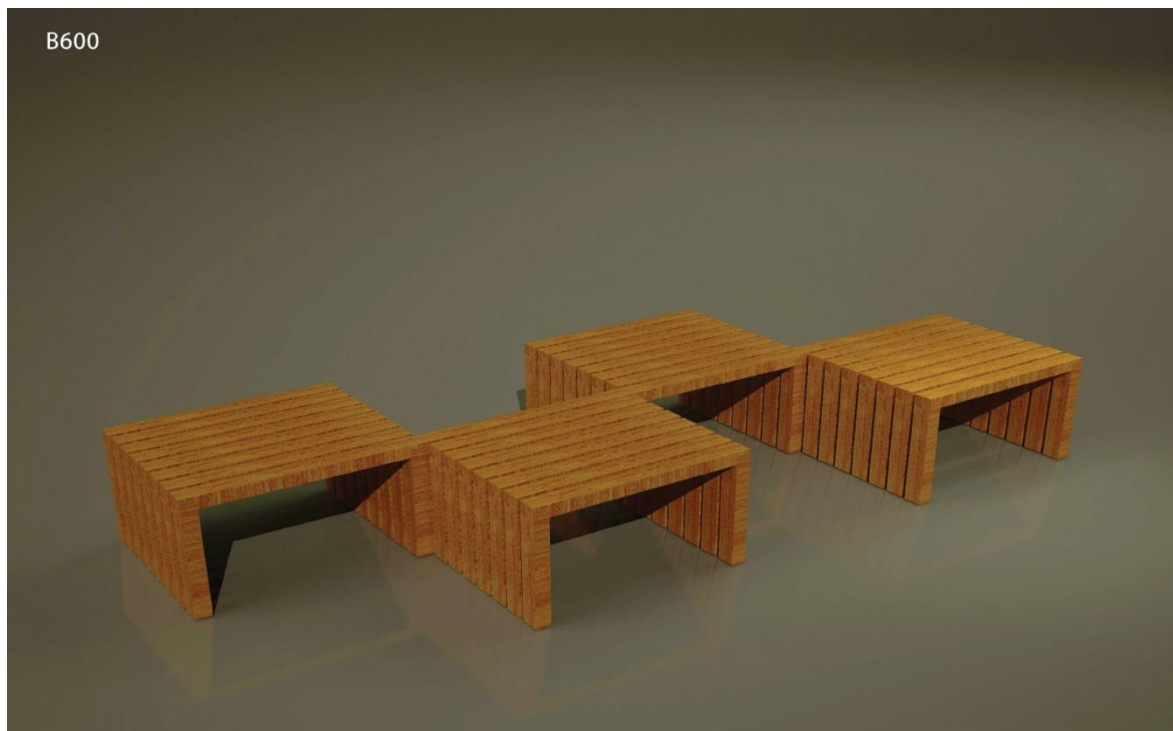

B500

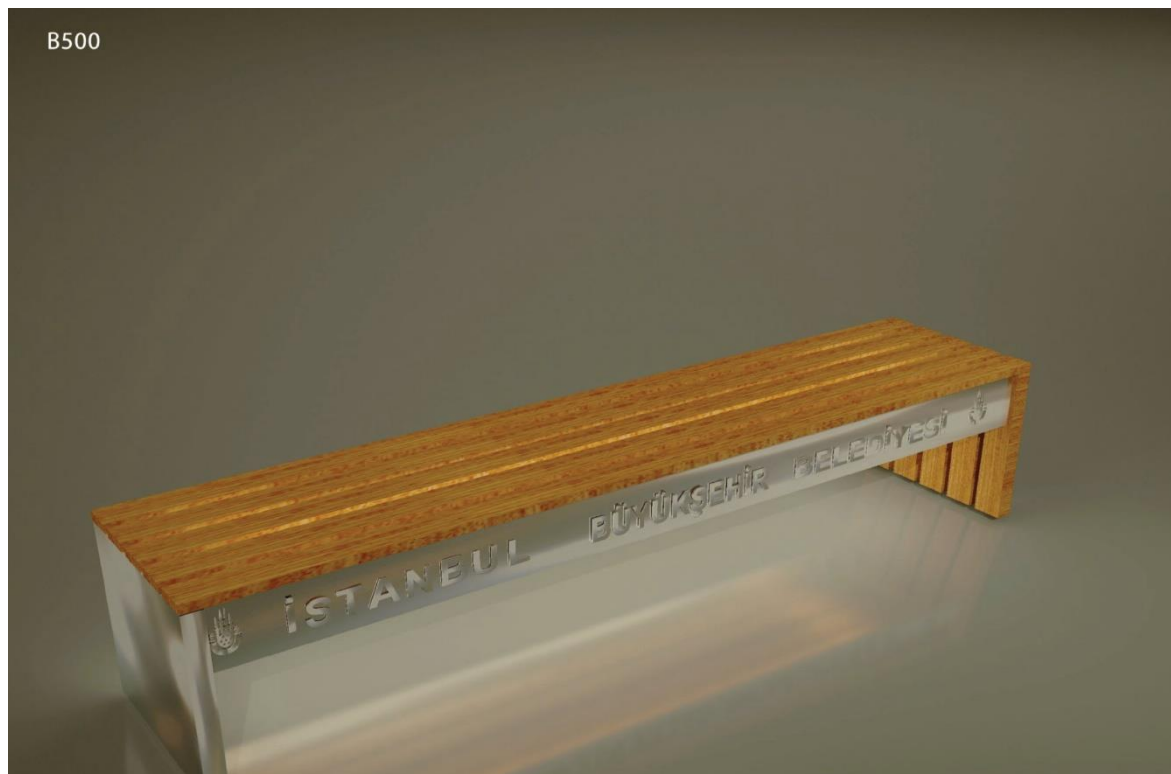

B400

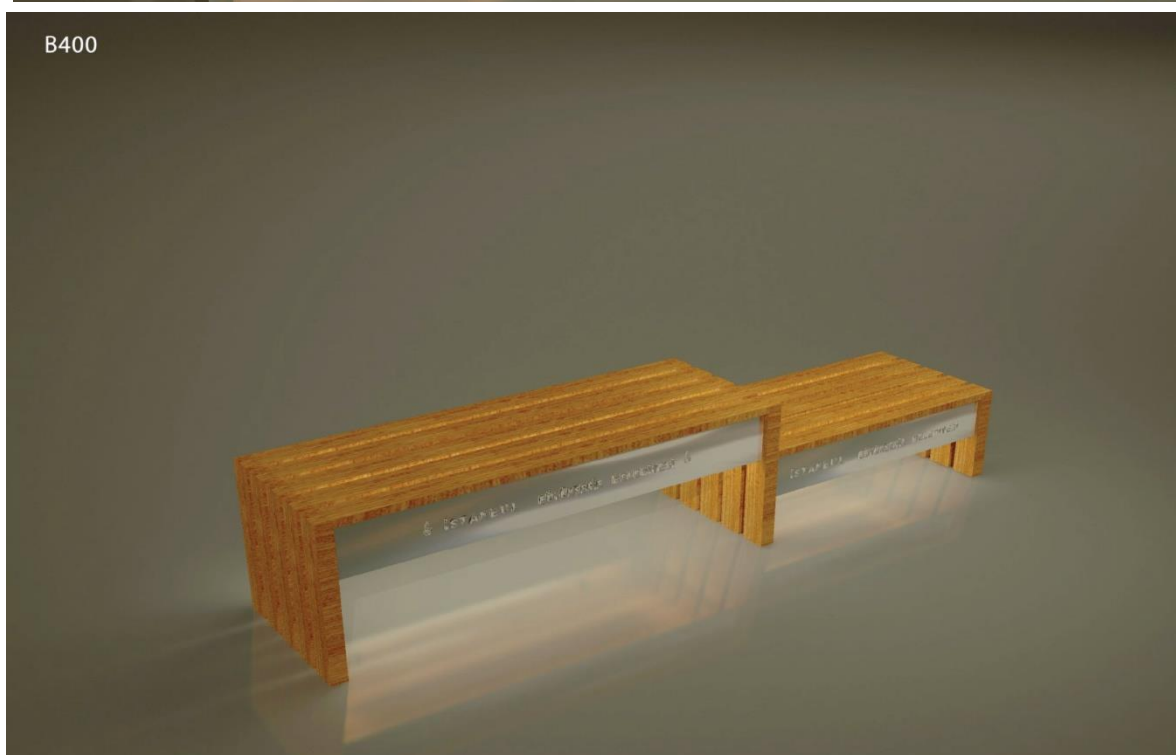

B300



B200



B100

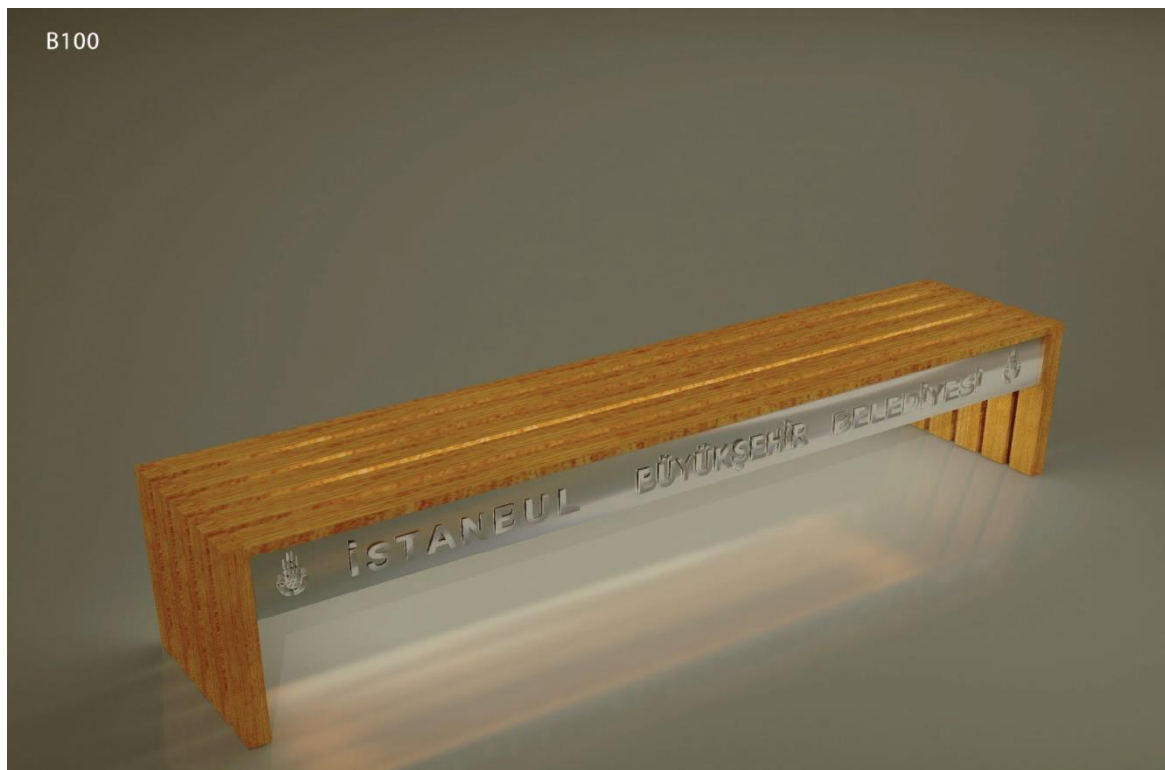

USK250

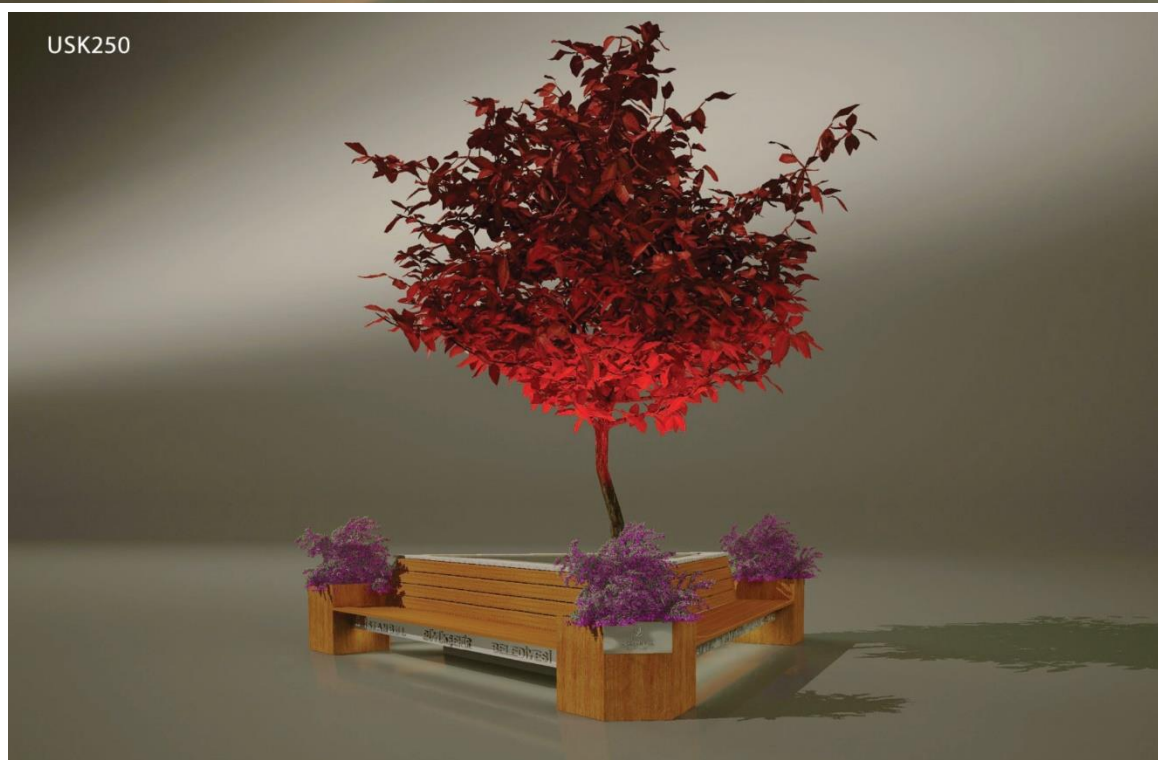

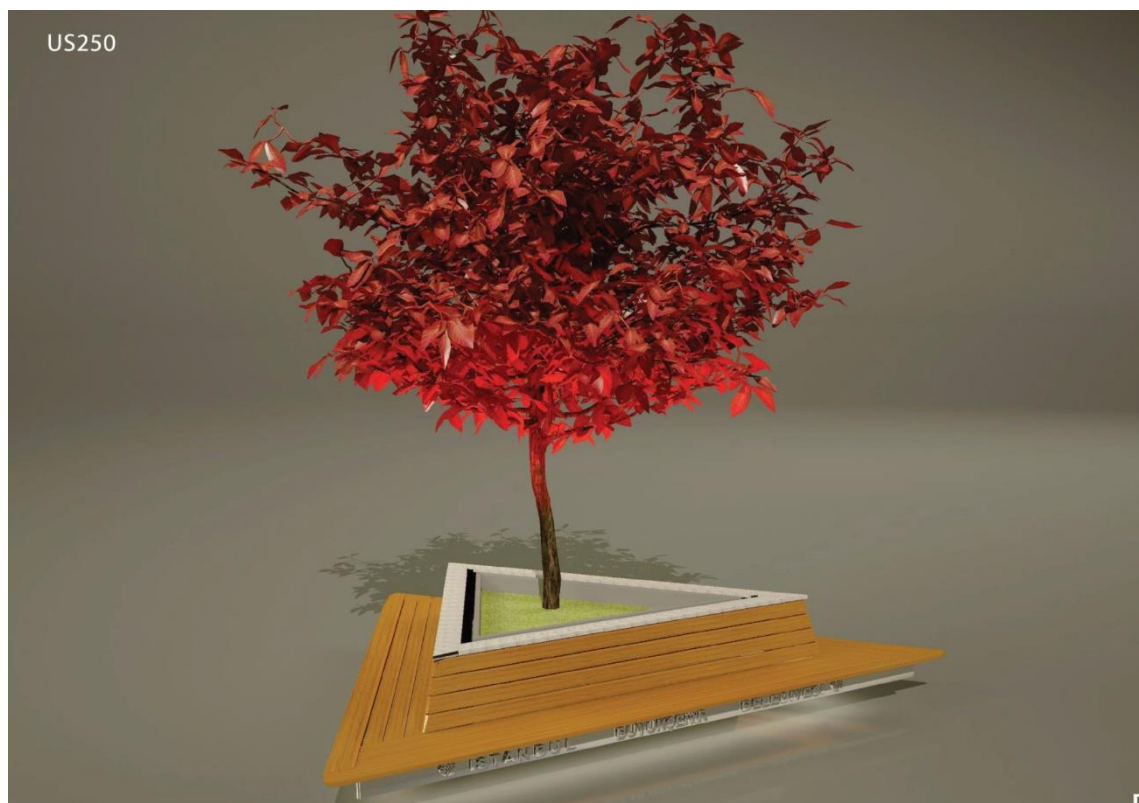

KD2040

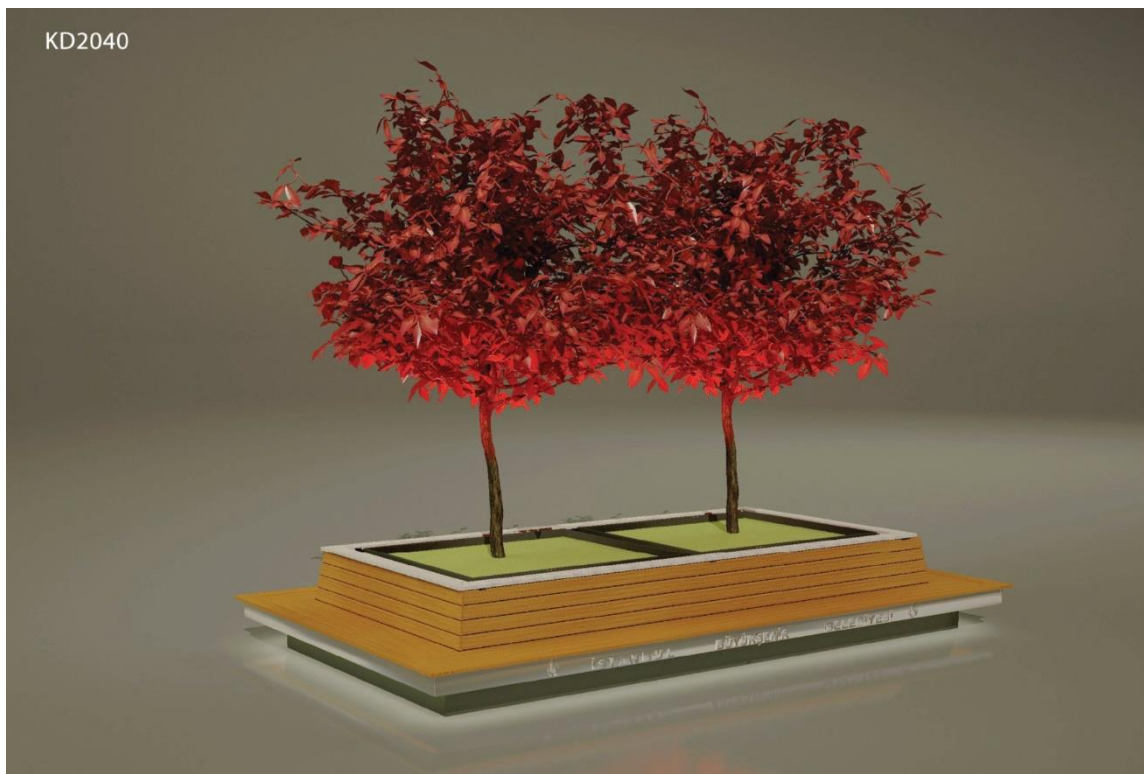

K20

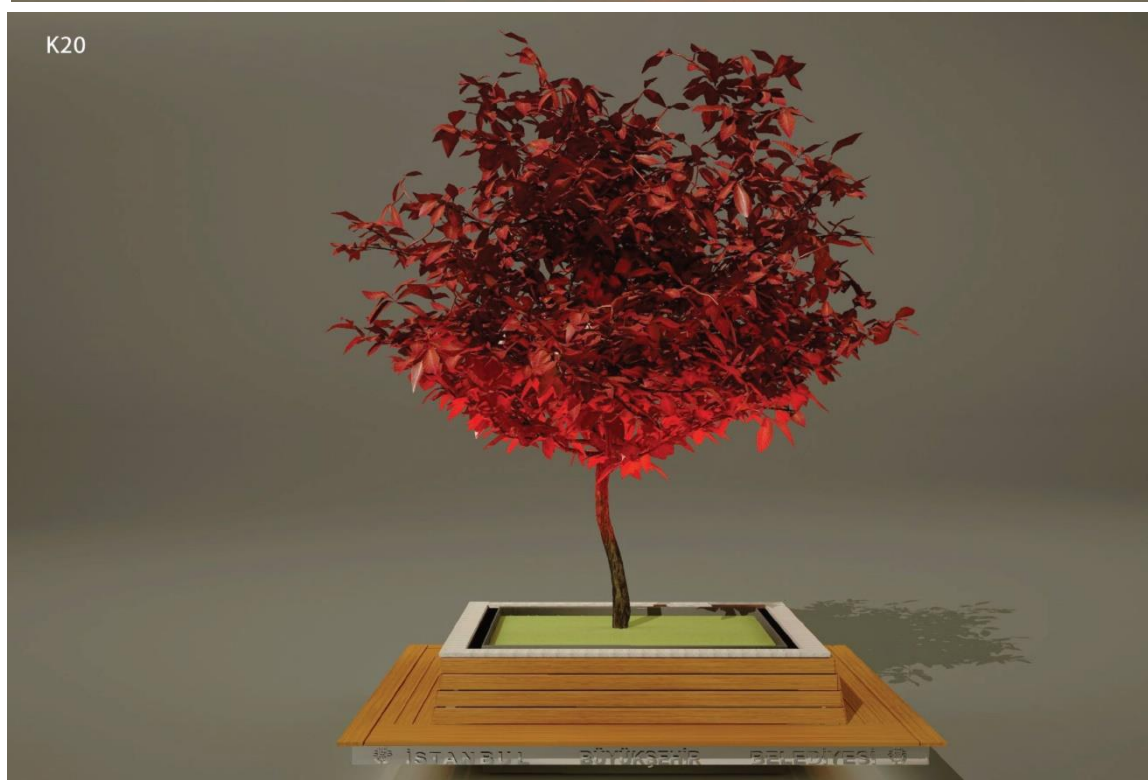

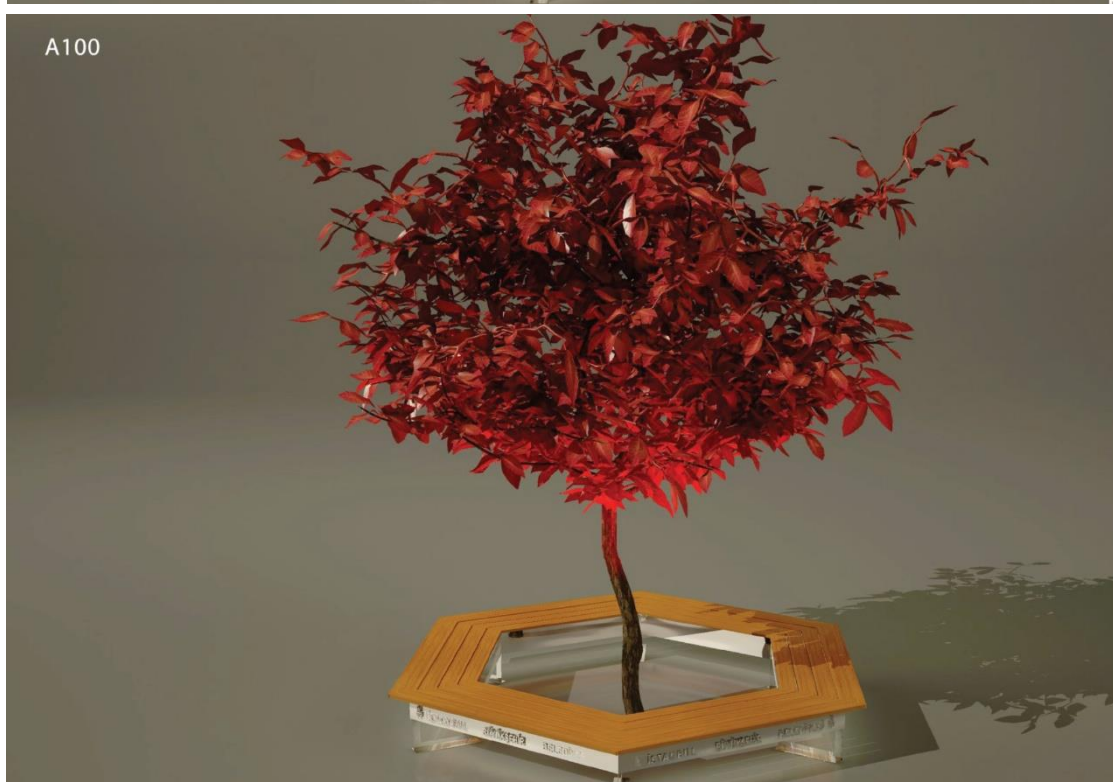

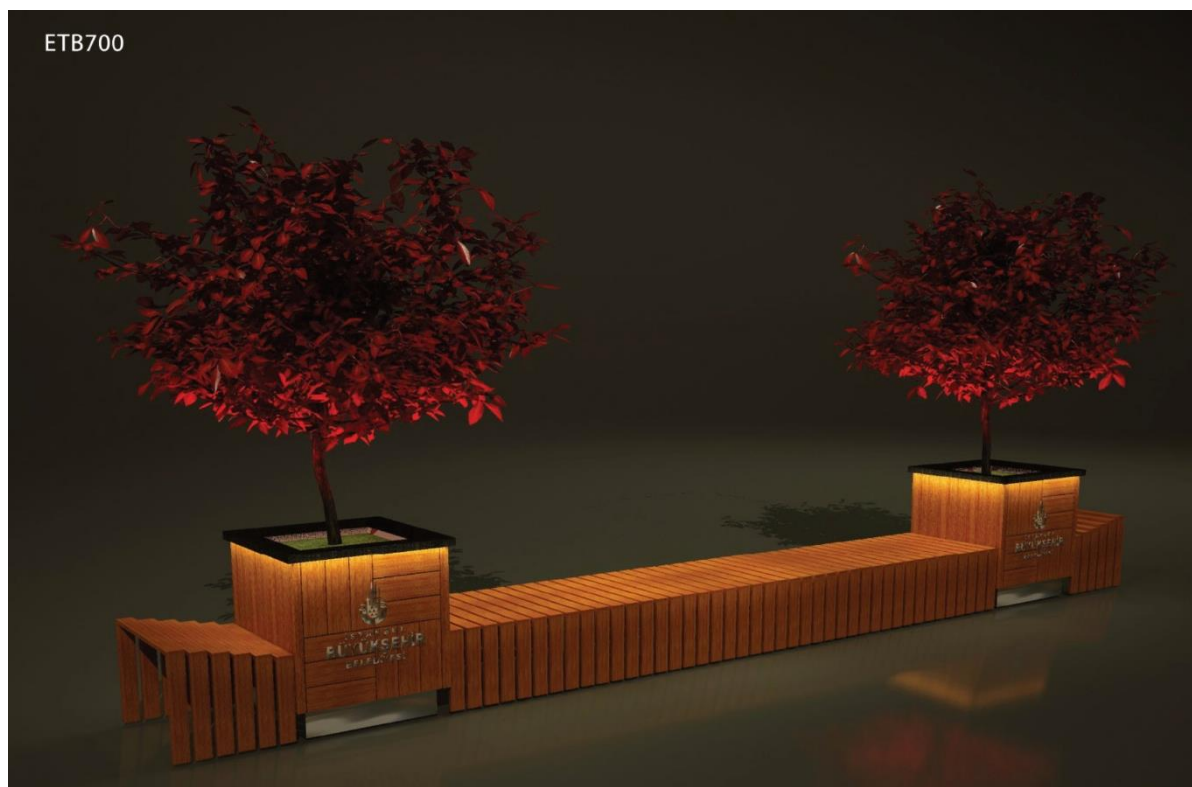

ETB700

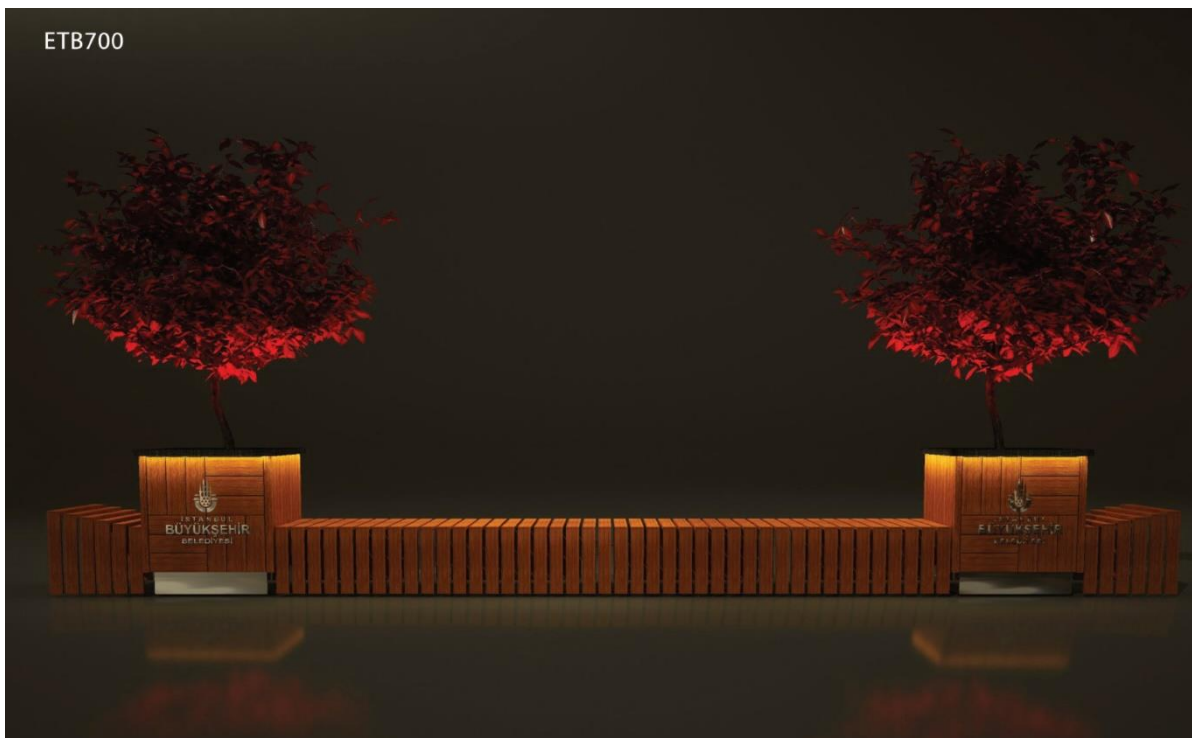

ETB500

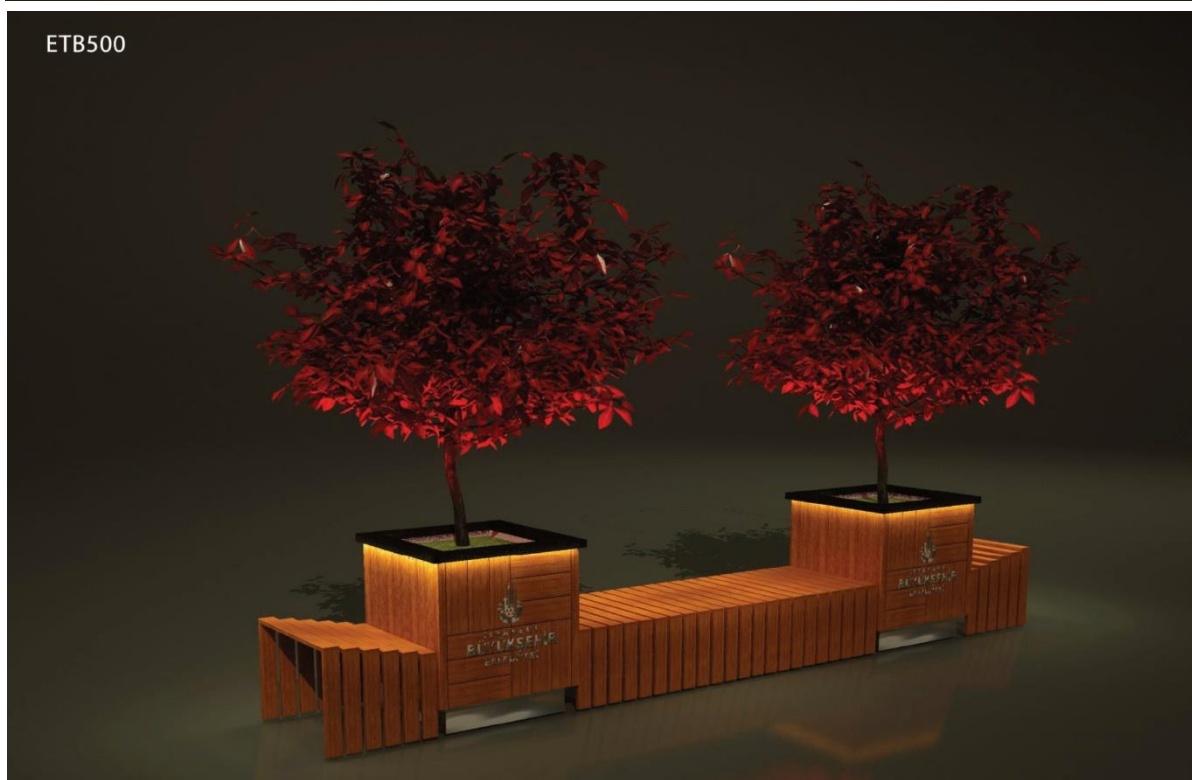

ETB500



ETB500

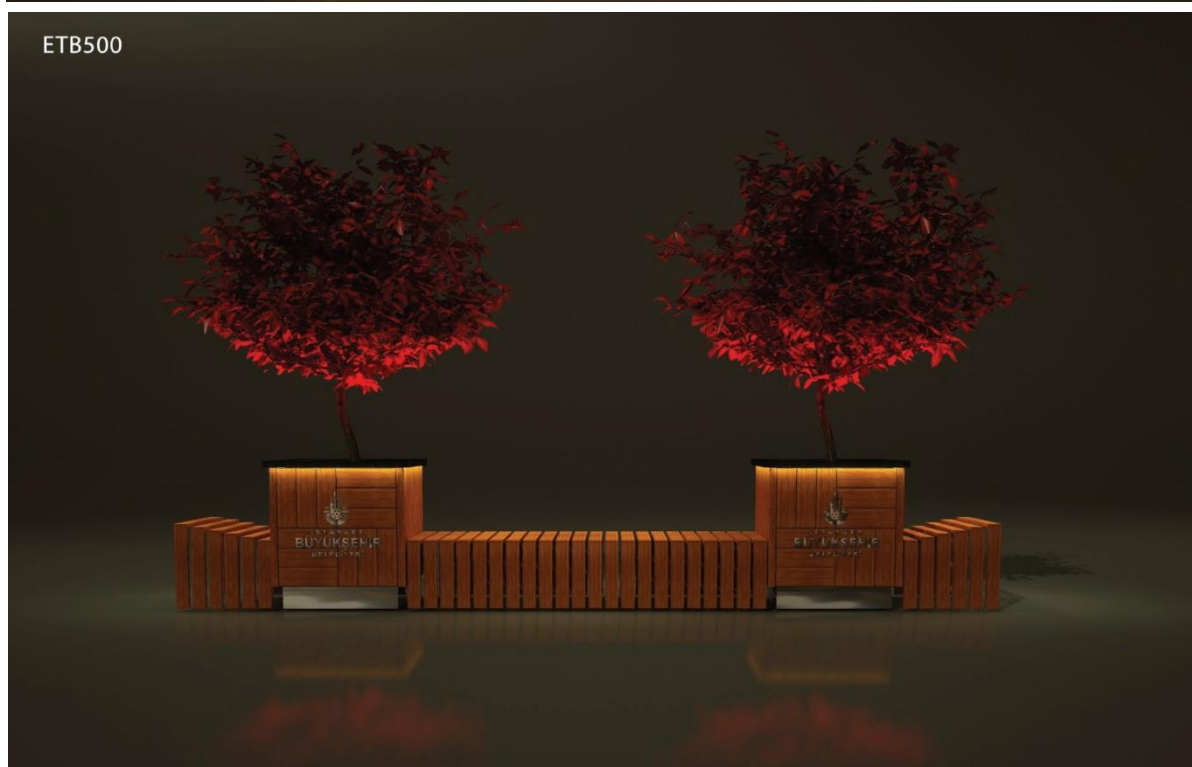

EAD-600

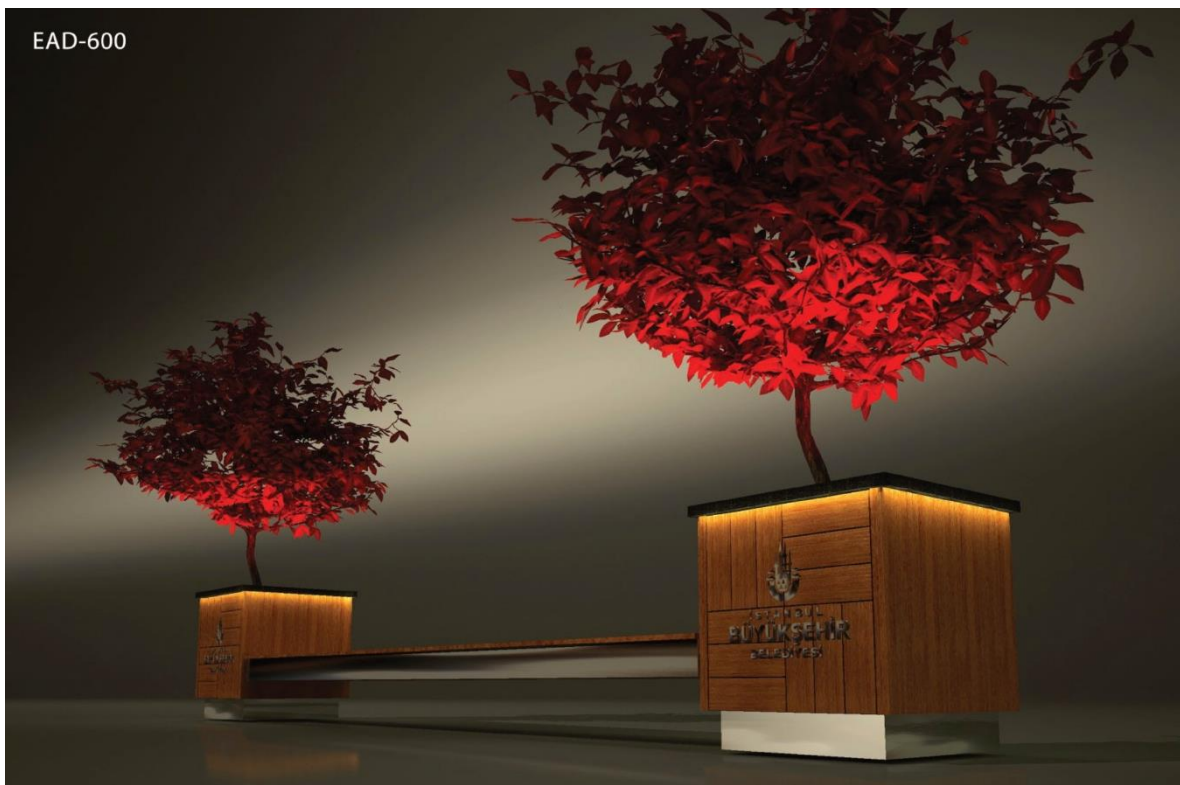

EAD-600

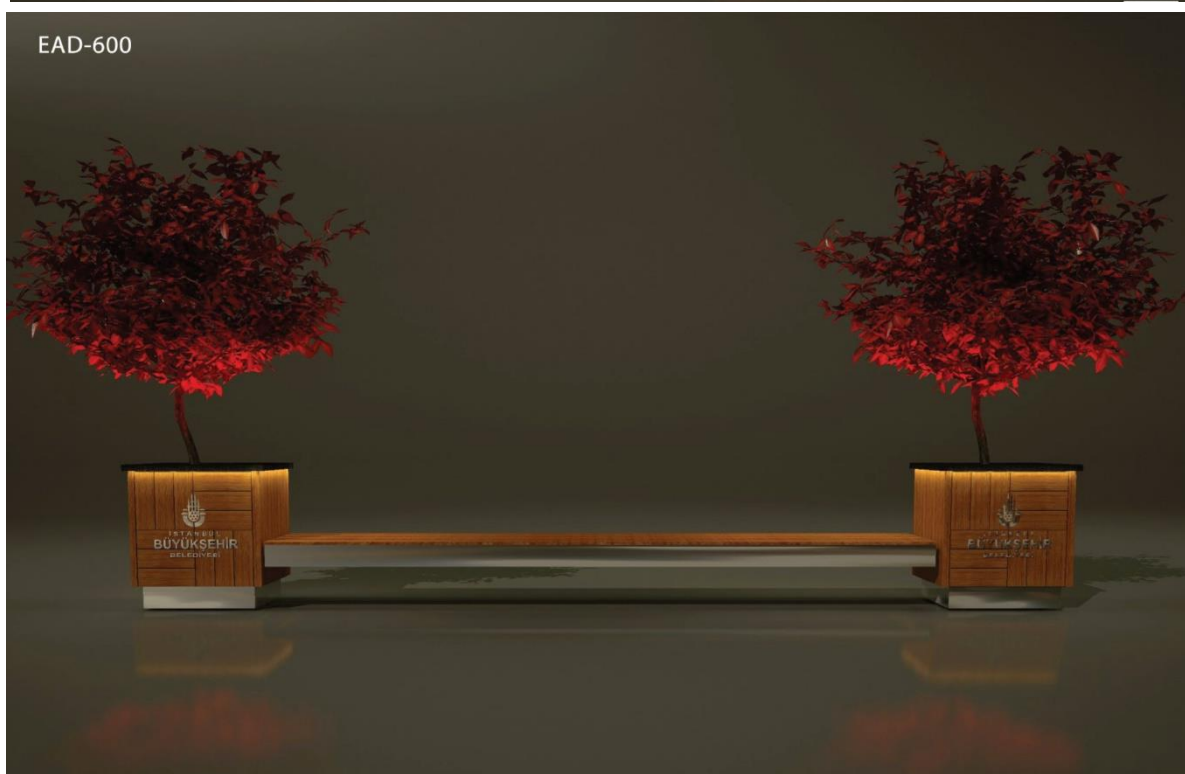

EAD-600

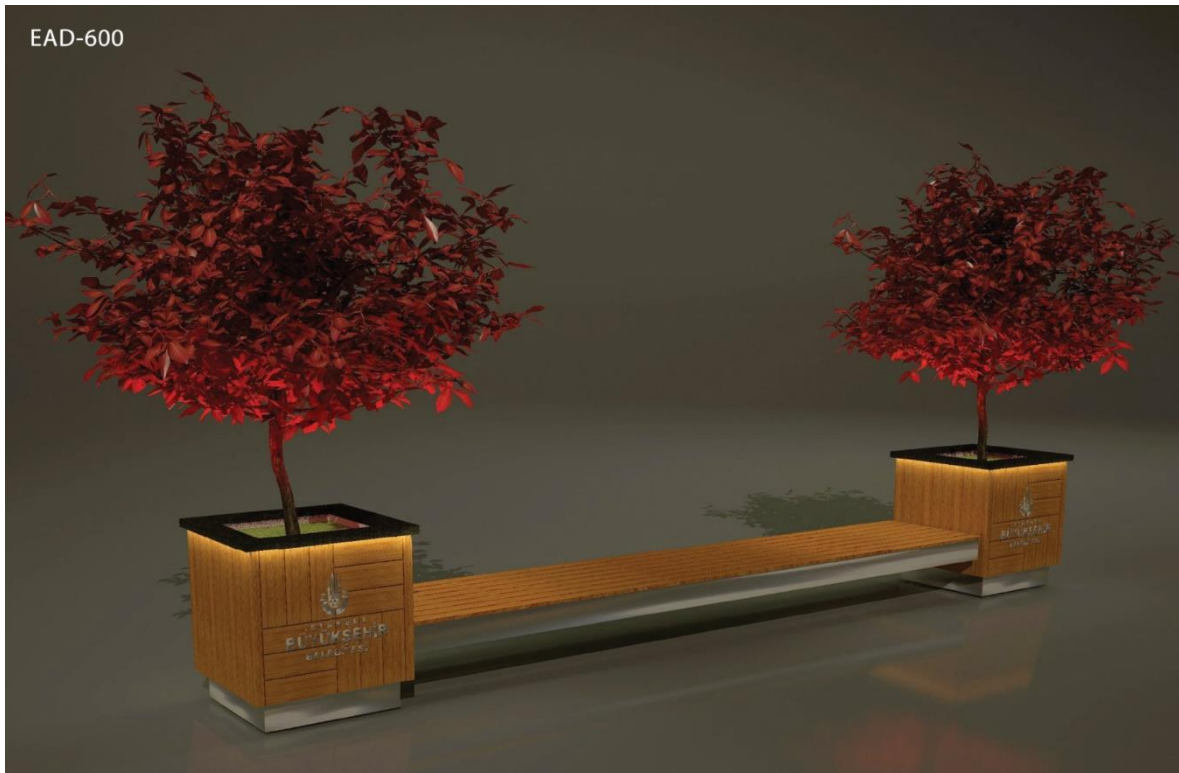

EAD-400

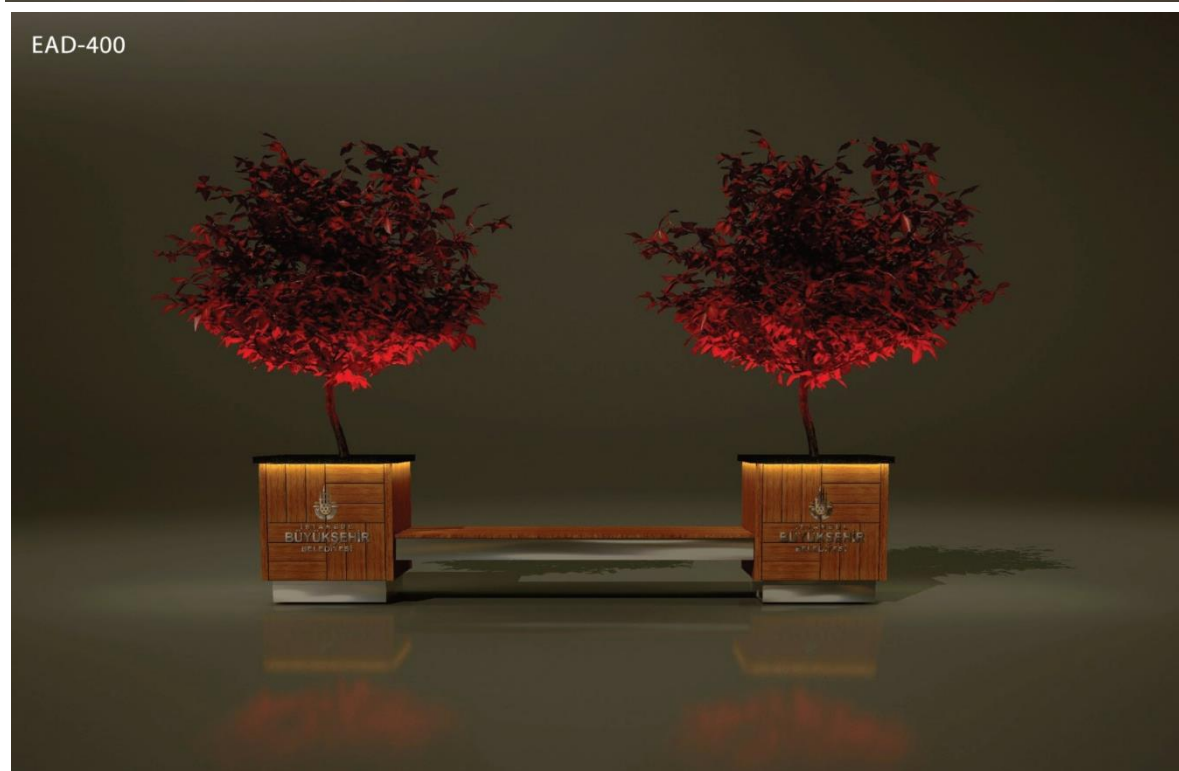



EAD-400



EAB600

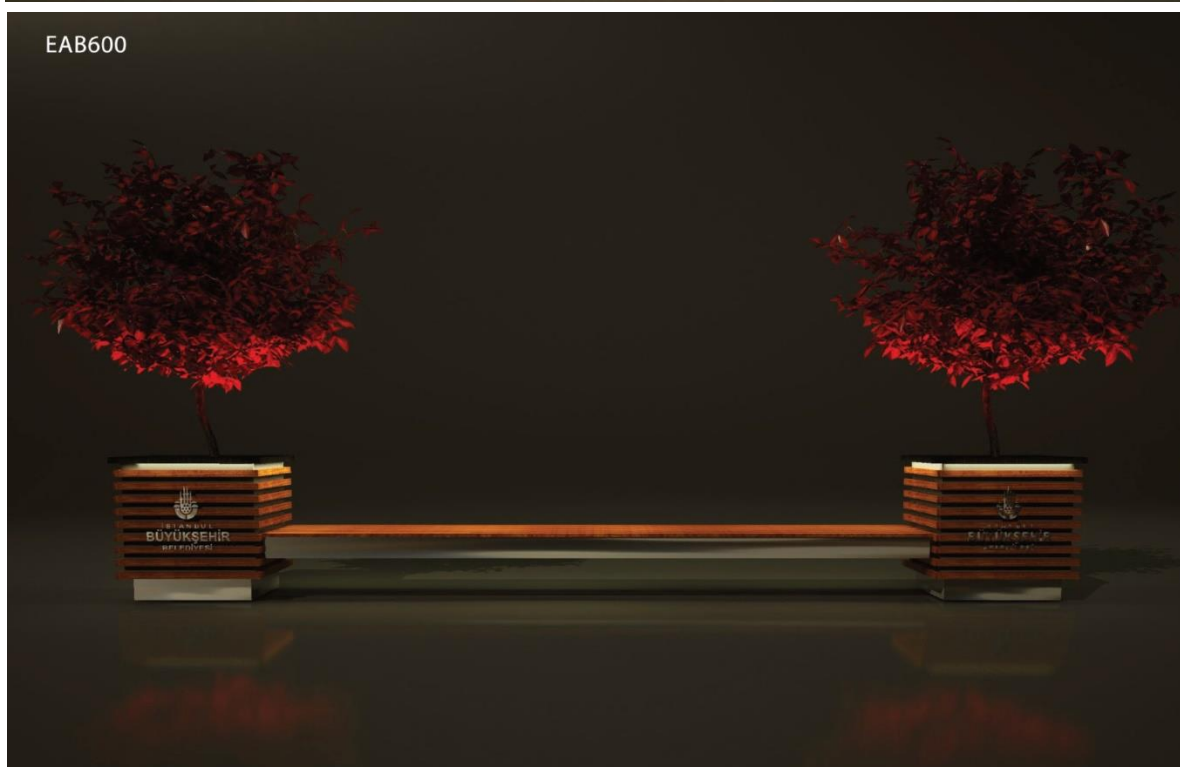

EAB600



EAB600

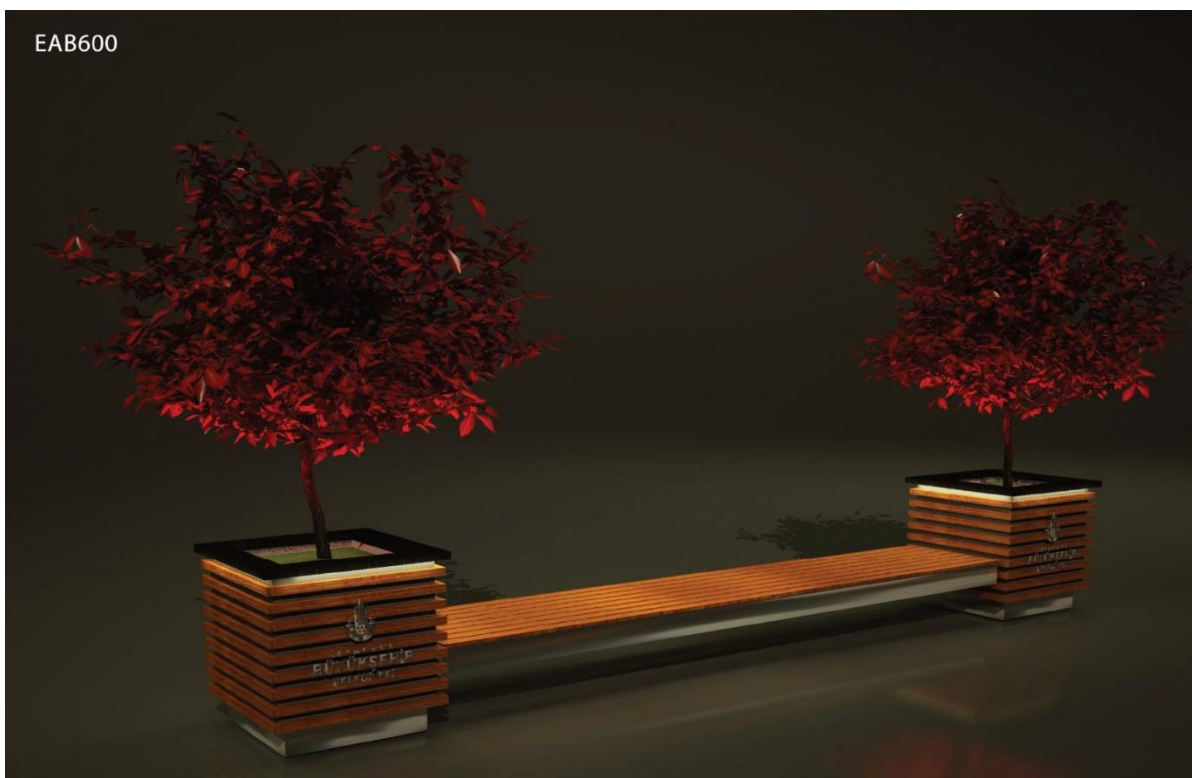

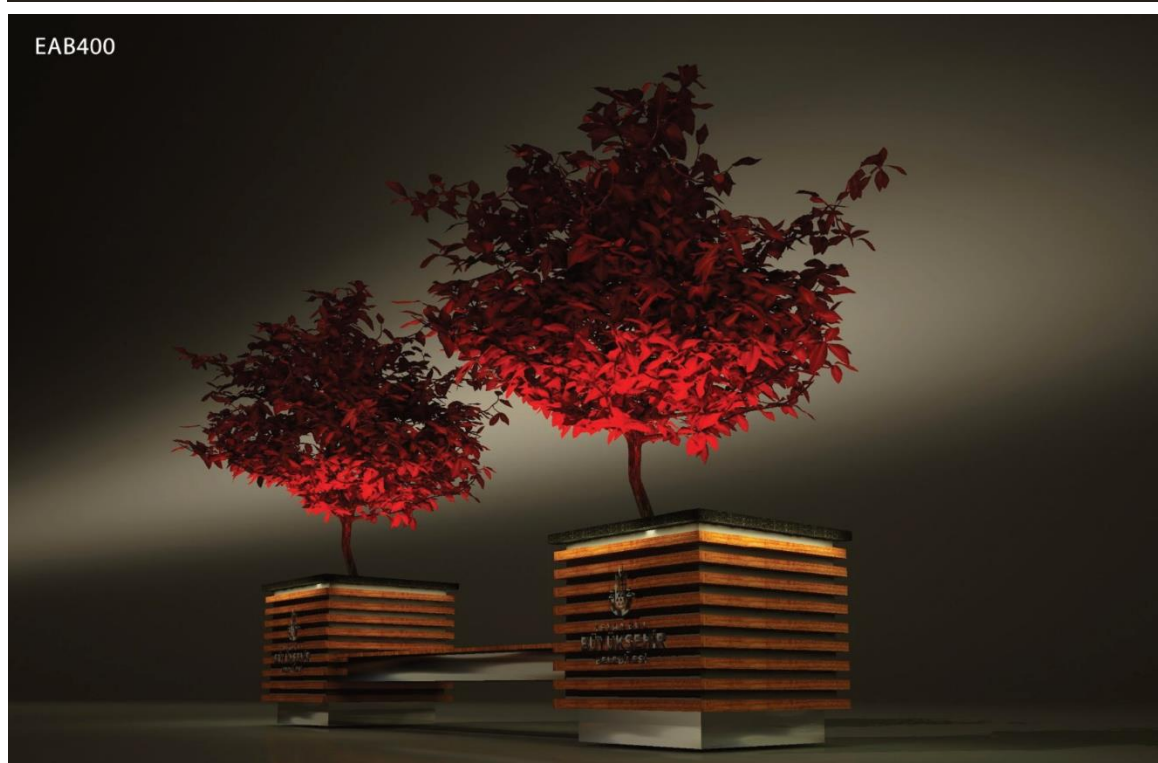
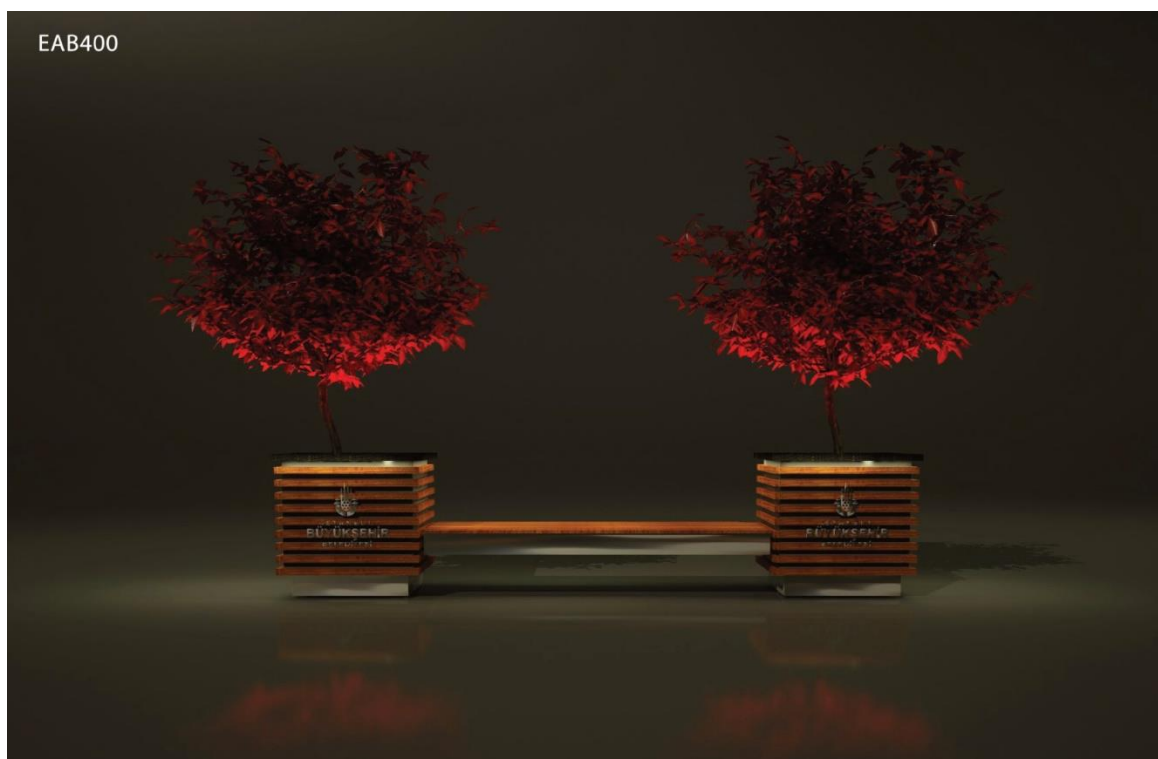

EAB400



מידע נוסף על הספסלים

DIMENSIONS

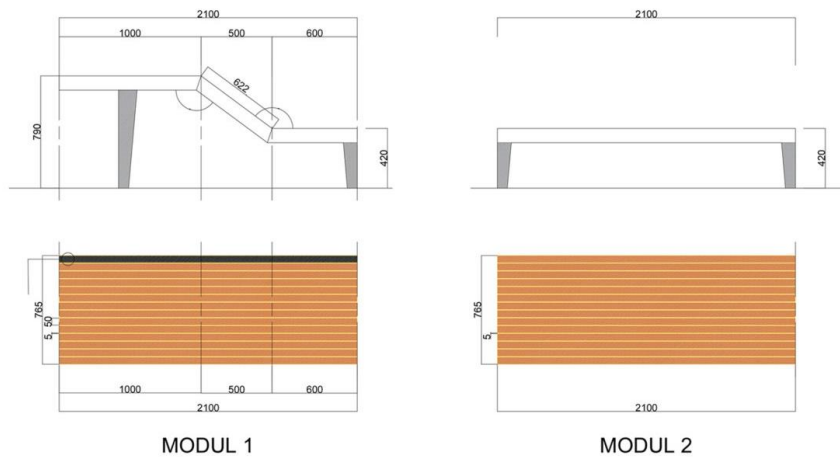

MATERIALS

Veneer Type: Teak

Color: 3901

Legs: Powder Coated Steel

FIXATION

Pre drilled for anchors

Hidden connection fixtures

Can be fixed to the ground upon request

SPECIFICATION

 %100 Natural wood veneer.
It does not bend, lose stability and crack in process of time.

 Has a Certificate of **A2 s1, d0 Class Fire Resistance**.

 It does not generate insect and fungi. It is non-toxic.
Its resistance against the most compelling conditions (desert etc) is high.

 By means of its 3 Dimensional Varnish, it cleanses itself in rain, it does not lose its natural wood looking.
Long maintenance periods and easy maintenance.



GENERAL SPECIFICATIONS

is a unique construction material, developed through intensive R&D efforts, with natural wood laminated over the superior features of GRP and Aluminum. With such a combination, our product became the indispensable new age wood product of the basic building-decoration materials.

The reasons of our choice of aluminum ;

- Low density, very light in weight (compared to steel and copper)
- A2 class fireproof
- Corrosion resistance
- Lightweight and durable (Because of its lightness and other benefits, it is also used in aircraft and aviation technology)
- Easily shaped
- Well known
- Easy recycling
- Flexible
- Very durable in all conditions

Apart from these positive features, its pulling and bending abilities are limited. This is why it is hard to use in situations where a huge pressure or load is involved. For such uses, GRP (Glass Reinforced Polyester) becomes an unrivaled choice.

ALUMINUM MATERIAL SPECIFICATIONS

COEFFICIENTS	VALUE	UNIT
SPECIFIC WEIGHT	2.71	GR / CM3
EXPANSION FACTOR	23,4 X 0,000001	1 / C
ELASTICITY MODULE	6900	KG / MM2
PULLING STRENGTH	17,5	24 C DE KG 7 MM2
ELONGATION	%8	24 C DE KG 7 MM2
HARDNESS	60-65	BRINELL(HB) KG/ MM2
YIELD STRENGTH	14	KG / MM2
SHEAR STRENGTH	13	KG / MM2
ALUMINUM ALLOY	AlMgSi0,5	DIN - ALMANYA
	6063	BS- İNGİLTERE
	60	ETIAL -TÜRKİYE

CLEANING AND CARE INSTRUCTIONS

- 1- For cleaning, a soft and damp cloth can be used. No cleaning liquid should be used in temperatures over 40°C. This can cause permanent plaque deposits to form over the paint.
- 2- The surface should not be cleaned with cleaning materials that contain alcohol and ammonia.
- 3- Before varnish treatment, it is essential that the surface is deprived from all kinds of foreign materials, oils, old paint residue, silicon and dust. A foam/sponge or 220 mm sandpaper can be used to do this.
- 4- With the help of a roller or brush, 2 or 3 coats of varnish is applied to the surface that is free of dust. The instructions given by the varnish producer should be complied with.
- 5- Ideal application temperature is between 15°C and 30°C. It is not recommended to be applied in temperatures below 10°C.
- 6- The relative humidity during the application should be below 80%. For maintenance, spring or summer months should be preferred.
- 7- Products that are exposed to sunlight can fade away in time. In order to prevent this, it is recommended to renew the varnishing, at least every 5 years, with water based varnish. This duration might be longer or shorter, depending on the duration of exposure to sunlight of the products.
- 8- If it is necessary to use a scaffolding or ladder for varnishing, necessary safety measures must be taken.
- 9- The disposal and/or recycling of the varnish/packaging of the applied varnish should be made in accordance with the legislations in power, preferably by a recognized collector or a certified company.
- 10- Keep the varnish that is used for maintenance away from children. Avoid eye or skin contact. In case of contact with eyes, rinse immediately with plenty of water and consult to a physician.



STORAGE INSTRUCTIONS

Regardless of the duration of storage, while doing stacking, the following issues and measures should be taken into account:

- 1- Materials should be stacked over one another, no more than 1 meters in length.
- 2- Chock height should be 10 cm, and the distance between chocks should be at least 1.5 meters.
- 3- If there is a wooden palette beneath the package, and if there are some materials protruding from the palette, they should be supported with wooden chocks, the same height as the palette itself.
- 4- The chocks in between the packages should be placed one on top of another, aligned in the same line.
- 5- Polyurethane or wooden chocks should be used only.
- 6- Never step on or walk over the stack or the panels that lie on the ground.
- 7- If the materials will be stored for a long time, their packages should be left open in order to prevent the dampening of the products.
- 8- The stacks should absolutely be kept in a covered warehouse, away from rain or humidity.





מידע נוסף על פחי אשפה

DIMENSIONS

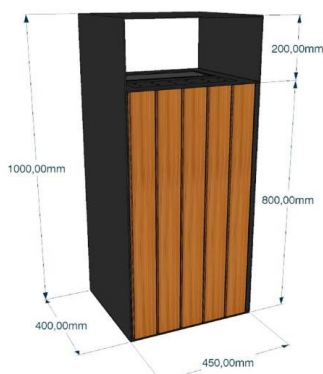

WEIGHT

Net Weight: 47,7 kg

Package Weight: 48,4 kg

MATERIALS

Veneer Type: Teak

Color: 3901

Legs: Powder Coated Steel

SPECIFICATION



%100 Natural wood veneer.

It does not bend, lose stability and crack in process of time.



Has a Certificate of **A2 s1, d0 Class Fire Resistance**.



It does not generate insect and fungi. It is non-toxic.

Its resistance against the most compelling conditions (desert etc) is high.



By means of its 3 Dimensional Varnish, it cleanses itself in rain, it does not lose its natural wood looking.

Long maintenance periods and easy maintenance.

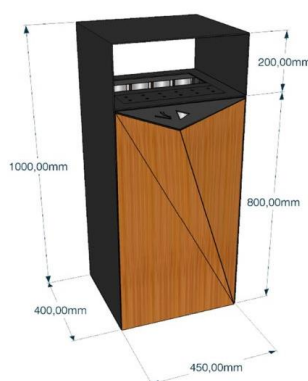

Net Weight: 53,9 kg

Package Weight: 54,6 kg

FIXATION

Pre drilled for anchors

Hidden connection fixtures

Can be fixed to the ground upon request



GENERAL SPECIFICATIONS

is a unique construction material, developed through intensive R&D efforts, with natural wood laminated over the superior features of GRP and Aluminum. With such a combination, our product became the indispensable new age wood product of the basic building-decoration materials.

The reasons of our choice of aluminum ;

- Low density, very light in weight (compared to steel and copper)
- A2 class fireproof
- Corrosion resistance
- Lightweight and durable (Because of its lightness and other benefits, it is also used in aircraft and aviation technology)
- Easily shaped
- Well known
- Easy recycling
- Flexible
- Very durable in all conditions

Apart from these positive features, its pulling and bending abilities are limited. This is why it is hard to use in situations where a huge pressure or load is involved. For such uses, GRP (Glass Reinforced Polyester) becomes an unrivaled choice.

ALUMINUM MATERIAL SPECIFICATIONS

COEFFICIENTS	VALUE	UNIT
SPECIFIC WEIGHT	2.71	GR / CM3
EXPANSION FACTOR	23,4 X 0,000001	1 / C
ELASTICITY MODULE	6900	KG / MM2
PULLING STRENGTH	17,5	24 C DE KG 7 MM2
ELONGATION	%8	24 C DE KG 7 MM2
HARDNESS	60-65	BRINELL(HB) KG/ MM2
YIELD STRENGTH	14	KG / MM2
SHEAR STRENGTH	13	KG / MM2
ALUMINUM ALLOY	AlMgSi0,5	DIN - ALMANYA
	6063	BS- İNGİLTERE
	60	ETIAL -TÜRKİYE

CLEANING AND CARE INSTRUCTIONS

- 1- For cleaning, a soft and damp cloth can be used. No cleaning liquid should be used in temperatures over 40°C. This can cause permanent plaque deposits to form over the paint.
- 2- The surface should not be cleaned with cleaning materials that contain alcohol and ammonia.
- 3- Before varnish treatment, it is essential that the surface is deprived from all kinds of foreign materials, oils, old paint residue, silicon and dust. A foam/sponge or 220 mm sandpaper can be used to do this.
- 4- With the help of a roller or brush, 2 or 3 coats of varnish is applied to the surface that is free of dust. The instructions given by the varnish producer should be complied with.
- 5- Ideal application temperature is between 15°C and 30°C. It is not recommended to be applied in temperatures below 10°C.
- 6- The relative humidity during the application should be below 80%. For maintenance, spring or summer months should be preferred.
- 7- Products that are exposed to sunlight can fade away in time. In order to prevent this, it is recommended to renew the varnishing, at least every 5 years, with water based varnish. This duration might be longer or shorter, depending on the duration of exposure to sunlight of the products.
- 8- If it is necessary to use a scaffolding or ladder for varnishing, necessary safety measures must be taken.
- 9- The disposal and/or recycling of the varnish/packaging of the applied varnish should be made in accordance with the legislations in power, preferably by a recognized collector or a certified company.
- 10- Keep the varnish that is used for maintenance away from children. Avoid eye or skin contact. In case of contact with eyes, rinse immediately with plenty of water and consult to a physician.

STORAGE INSTRUCTIONS

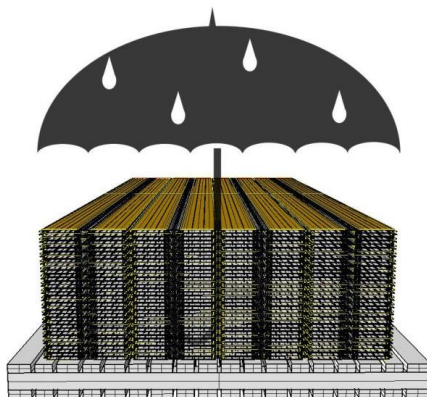

Regardless of the duration of storage, while doing stacking, the following issues and measures should be taken into account:

- 1- Materials should be stacked over one another, no more than 1 meters in length.
- 2- Chock height should be 10 cm, and the distance between chocks should be at least 1.5 meters.
- 3- If there is a wooden palette beneath the package, and if there are some materials protruding from the palette, they should be supported with wooden chocks, the same height as the palette itself.
- 4- The chocks in between the packages should be placed one on top of another, aligned in the same line.
- 5- Polyurethane or wooden chocks should be used only.
- 6- Never step on or walk over the stack or the panels that lie on the ground.
- 7- If the materials will be stored for a long time, their packages should be left open in order to prevent the dampening of the products.
- 8- The stacks should absolutely be kept in a covered warehouse, away from rain or humidity.

מידע נוסף על מתקני אופנים

DIMENSIONS



WEIGHT

Net Weight: 24,7 kg

Package Weight: 45,4 kg

DIMENSIONS

217x 132 x H1000 mm

MATERIALS

Veneer Type: Teak

Color: 3901

Body: Powder Coated Steel

FIXATION

Hidden connection fixtures

Can be fixed to the ground upon request

SPECIFICATION



%100 Natural wood veneer.

It does not bend, lose stability and crack in process of time.



Has a Certificate of **A2 s1, d0 Class Fire Resistance**.



It does not generate insect and fungi. It is non-toxic.

Its resistance against the most compelling conditions (desert etc) is high.



By means of its 3 Dimensional Varnish, it cleanses itself in rain, it does not lose its natural wood looking.

Long maintenance periods and easy maintenance.



GENERAL SPECIFICATIONS

is a unique construction material, developed through intensive R&D efforts, with natural wood laminated over the superior features of GRP and Aluminum. With such a combination, our product became the indispensable new age wood product of the basic building-decoration materials.

The reasons of our choice of aluminum ;

- Low density, very light in weight (compared to steel and copper)
- A2 class fireproof
- Corrosion resistance
- Lightweight and durable (Because of its lightness and other benefits, it is also used in aircraft and aviation technology)
- Easily shaped
- Well known
- Easy recycling
- Flexible
- Very durable in all conditions

Apart from these positive features, its pulling and bending abilities are limited. This is why it is hard to use in situations where a huge pressure or load is involved. For such uses, GRP (Glass Reinforced Polyester) becomes an unrivaled choice.

ALUMINUM MATERIAL SPECIFICATIONS

COEFFICIENTS	VALUE	UNIT
SPECIFIC WEIGHT	2.71	GR / CM3
EXPANSION FACTOR	23,4 X 0,000001	1 / C
ELASTICITY MODULE	6900	KG / MM2
PULLING STRENGTH	17,5	24 C DE KG 7 MM2
ELONGATION	%8	24 C DE KG 7 MM2
HARDNESS	60-65	BRINELL(HB) KG/ MM2
YIELD STRENGTH	14	KG / MM2
SHEAR STRENGTH	13	KG / MM2
ALUMINUM ALLOY	AlMgSi0,5	DIN - ALMANYA
	6063	BS- İNGİLTERE
	60	ETIAL -TÜRKİYE

CLEANING AND CARE INSTRUCTIONS

- 1- For cleaning, a soft and damp cloth can be used. No cleaning liquid should be used in temperatures over 40°C. This can cause permanent plaque deposits to form over the paint.
- 2- The surface should not be cleaned with cleaning materials that contain alcohol and ammonia.
- 3- Before varnish treatment, it is essential that the surface is deprived from all kinds of foreign materials, oils, old paint residue, silicon and dust. A foam/sponge or 220 mm sandpaper can be used to do this.
- 4- With the help of a roller or brush, 2 or 3 coats of varnish is applied to the surface that is free of dust. The instructions given by the varnish producer should be complied with.
- 5- Ideal application temperature is between 15°C and 30°C. It is not recommended to be applied in temperatures below 10°C.
- 6- The relative humidity during the application should be below 80%. For maintenance, spring or summer months should be preferred.
- 7- Products that are exposed to sunlight can fade away in time. In order to prevent this, it is recommended to renew the varnishing, at least every 5 years, with water based varnish. This duration might be longer or shorter, depending on the duration of exposure to sunlight of the products.
- 8- If it is necessary to use a scaffolding or ladder for varnishing, necessary safety measures must be taken.
- 9- The disposal and/or recycling of the varnish/packaging of the applied varnish should be made in accordance with the legislations in power, preferably by a recognized collector or a certified company.
- 10- Keep the varnish that is used for maintenance away from children. Avoid eye or skin contact. In case of contact with eyes, rinse immediately with plenty of water and consult to a physician.

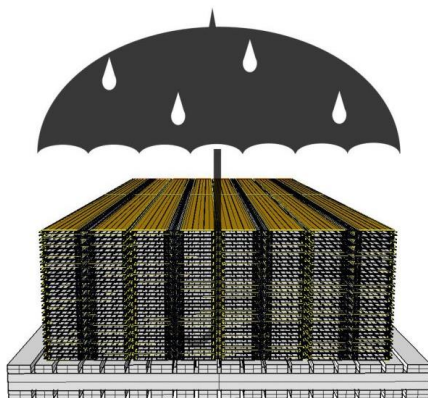

STORAGE INSTRUCTIONS

Regardless of the duration of storage, while doing stacking, the following issues and measures should be taken into account:

- 1- Materials should be stacked over one another, no more than 1 meters in length.
- 2- Chock height should be 10 cm, and the distance between chocks should be at least 1.5 meters.
- 3- If there is a wooden palette beneath the package, and if there are some materials protruding from the palette, they should be supported with wooden chocks, the same height as the palette itself.
- 4- The chocks in between the packages should be placed one on top of another, aligned in the same line.
- 5- Polyurethane or wooden chocks should be used only.
- 6- Never step on or walk over the stack or the panels that lie on the ground.
- 7- If the materials will be stored for a long time, their packages should be left open in order to prevent the dampening of the products.
- 8- The stacks should absolutely be kept in a covered warehouse, away from rain or humidity.

